

A1 INSTALLATION DRAWING

IF THIS DOCUMENT IS PRINTED IN HARDCOPY, IT IS FOR INFORMATION USE ONLY AND THEREFORE IS NOT SUBJECT TO UPDATING CONTROLS. ALWAYS REFER TO SOLIDWORKS VIEWER FOR LATEST ISSUE

FIRST ANGLE PROJECTION

THIS DRAWING IS CONFIDENTIAL AND IS SUPPLIED ON THE EXPRESS CONDITION THAT IT SHALL NOT BE LOANED OR COPIED OR DISCLOSED TO ANY OTHER PERSON OR USED FOR ANY OTHER PURPOSE WITHOUT THE WRITTEN CONSENT OF AP RACING LTD.



AP Racing
Wheler Road
Coventry
CV3 4LB

Tel: +44 (0) 24 7663 9595
Fax: +44 (0) 24 7663 9559
e-mail: engineering@apracings.co.uk
Web site: <http://www.apracings.com>

© AP Racing Ltd. 2005

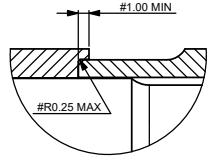

DETAIL F SCALE 4 : 1

MOUNTING HOLES,
8 HOLES Ø8.15/8.05
EQUISPACED ON A
Ø154.35 P.C.
MIN. REQUIRE Ø17.22
Ø 0.05

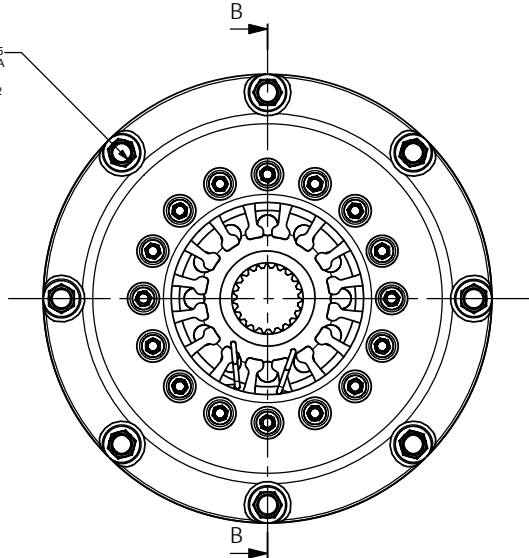

THE CLUTCH SPIGOT IS DESIGNED TO BE THIS DIMENSION BEFORE BEING MOUNTED TO THE FLYWHEEL. IF THE DIMENSION OF THE SPIGOT (INSTALLATION WIRE IN PLACE) THIS DIA. MAY BE SLIGHTLY REDUCED.

Ø168.07/165.93
Ø165.98/165.93

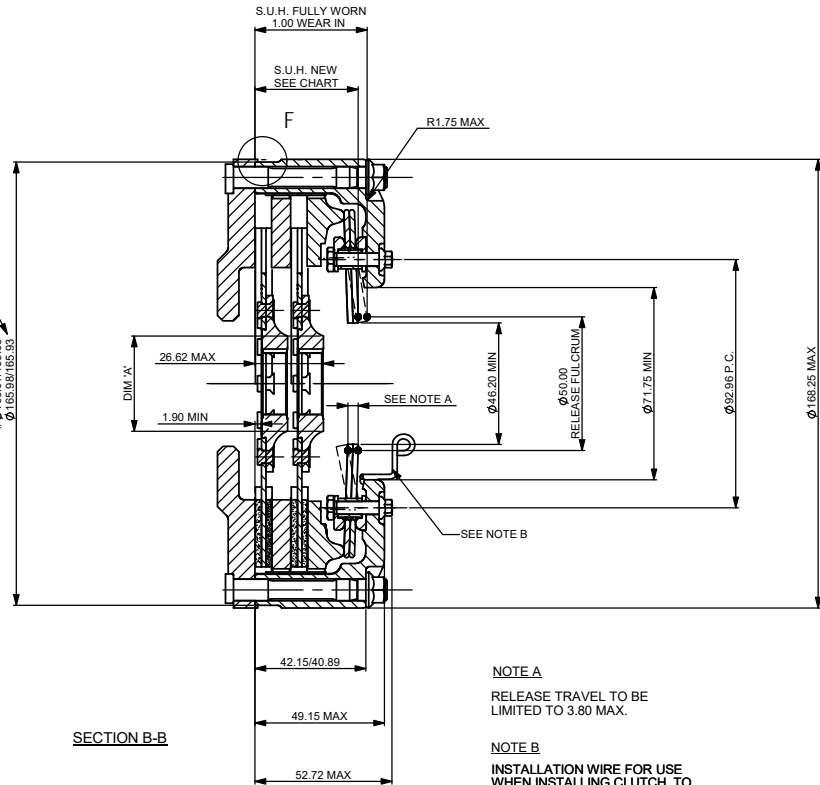

SECTION B-B

NOTE A
RELEASE TRAVEL TO BE LIMITED TO 3.80 MAX.

NOTE B
INSTALLATION WIRE FOR USE WHEN INSTALLING CLUTCH, TO ENSURE EASY FITMENT OF COVER. THIS WIRE MUST BE REMOVED BEFORE USE.

RECOMMENDED RELEASE BEARING :-

STEEL CAGED, ROUND NOSED BALL TYPE BEARING TO BE FREE OF SPRING FINGERS WHEN CLUTCH IS FULLY ENGAGED.
CP3457-4 STANDARD RELEASE BEARING (OUTER RACE ROTATES)
CP3457-5 HIGH SPEED RELEASE BEARING (INNER RACE ROTATES).

SUGGESTED FLYWHEEL MATERIAL :-

0.35/0.45% CARBON STEEL. BRINELL 200 MIN. OR SUITABLE MATERIAL FOR HIGH RPM.
FRICTION FACE TO BE FINE TURNED AND GROUND SMOOTH AND FLAT. RUNOUT AT R77.2 <=0.08 MAX. WHEN ASSEMBLED TO CRANKSHAFT.

TORQUE CAPACITY :-

FOR APPLICATIONS EXCEEDING THE MAXIMUM RECOMMENDED FIGURES PLEASE CONTACT A.P. RACING.

CLUTCH 'WEAR IN'

THIS CLUTCH HAS BEEN DESIGNED TO ACHIEVE 1.00mm 'WEAR IN' MINIMUM.
DRIVEN PLATE THICKNESS NEW: 6.25 NOM
DRIVEN PLATE THICKNESS WORN: 5.71 MIN

FACING MATERIAL

CP4581 DRIVEN PLATES CARRY AP RACING'S HIGH PERFORMANCE FRICTION MATERIAL IN A NEW SINTERED 3 PADDLE CONFIGURATION. THIS COMBINING EXCELLENT PERFORMANCE AND LOW WEAR WITH REDUCED INERTIA.

DRIVEN PLATES		
SPLINE SIZE	BACK TO BACK TYPE PART NO'S	DIM 'A'
1"5/32" X 26	CP4581-3	35.65
1" X 23	CP4581-4	35.65
7/8" X 20	CP4581-5	27.85
29.0 X 10	CP4581-6	35.65

CLUTCH ASSY PART No.	SET UP HEIGHT		RECOMMENDED MAX. DYNAMIC TORQUE CAPACITY Nm (lb.ft)	RELEASE LOAD (N)		COMPLETE ASSY. WEIGHT INC D/PLTS.	COMPLETE ASSY. INERTIA INC D/PLTS.	D/PLATE AND HUB INERTIA
	NEW	MAX WORN		MAX. PEAK WORN	MAX. PEAK NEW			
CP6092ACRV	39.37	42.01	398 (294)	5400	3600	3.30 kg	0.01155 kg.m ²	0.00180 kg.m ²
	37.91	(1.00mm WEAR IN)						
CP6092AORA	39.11	41.75	298 (220)	4000	3100	3.30 kg	0.01155 kg.m ²	0.00180 kg.m ²
	37.65	(1.00mm WEAR IN)						

ISSUE No.	Date & No.	Alterations Particulars	Zone	Initials
1	15/03/99 C 1248	FIRST ISSUE	RG	
2	28/07/10 C3901	TORQUE CAPACITY CHANGED FROM 504Nm AND 371Nm TO 398Nm and 314Nm	AB	
3	17/08/21 C5375_01	'MAX PEAK NEW' WAS 'AT TRAVEL' 'MAX PEAK WORN' AND 'MAX PEAK NEW' VALUES CORRECTED TO CONFORM WITH MIS1000 'N' WAS '64N'	B8	JRV
			A7	
			B8	

SCALE 1:1	SHEET 1 OF 1
DRAWN	RICHARD GOSTICK
APPROVED	
DERIVED FROM	
TITLE	5.5" SINTERED CLUTCH INSTALLATION DRAWING
DRG NO.	CP6092-1CD